

Plan Vertical Concept

Double Convector Type 22

Height mm	Length mm	Henrad Code	Heat emissions	
			Watts	Btu/hr
1800	400	4282204	1476	5036
	500	4282205	1845	6295
	600	4282206	2214	7554

Btu/hr @ $\Delta t 50^{\circ}\text{C}$



Plan Vertical Concept is only available
in Slate grey RAL A7015.

For technical and installation information
visit our website www.henrad.co.uk/downloads

Centre Tap TRV
Available from stock



UIN	Henrad Description
14531310	Centre Tap TRV Straight White - 10mm
14531312	Centre Tap TRV Straight White - 1/2in
14531315	Centre Tap TRV Straight White - 15mm
14531410	Centre Tap TRV Straight Chrome - 10mm
14531412	Centre Tap TRV Straight Chrome - 1/2in
14531415	Centre Tap TRV Straight Chrome - 15mm
14531510	Centre Tap TRV Angled L White - 10mm
14531512	Centre Tap TRV Angled L White - 1/2in
14531515	Centre Tap TRV Angled L White - 15mm
14531610	Centre Tap TRV Angled L Chrome - 10mm
14531612	Centre Tap TRV Angled L Chrome - 1/2in
14531615	Centre Tap TRV Angled L Chrome - 15mm

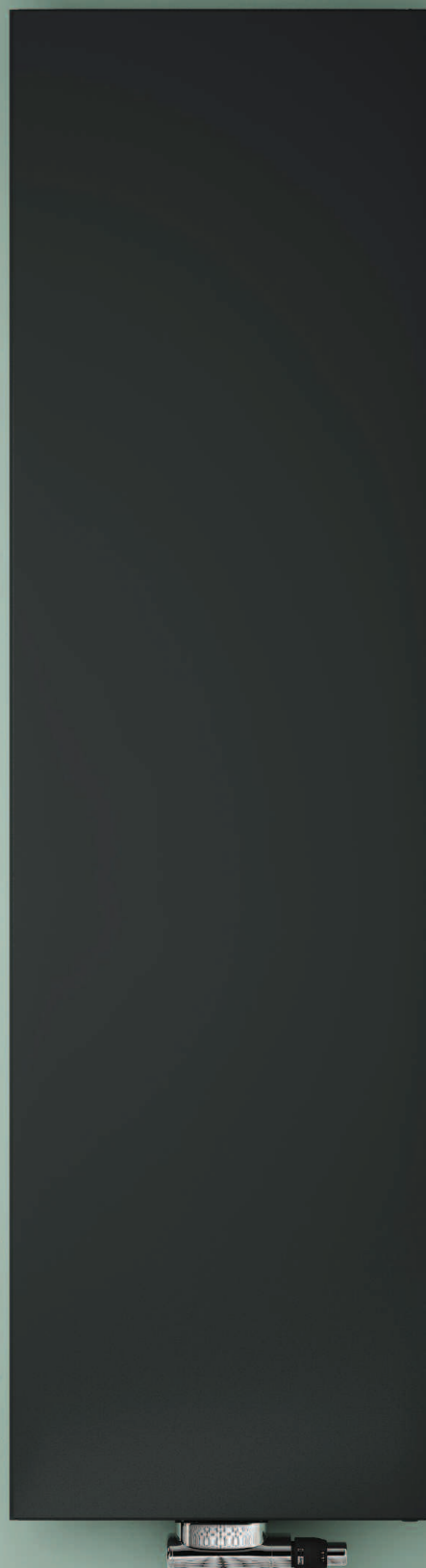

Technical information

Testing and Operating Pressures

Henrad Plan Vertical Concept has been independently tested to ensure these radiators perform to a maximum working pressure of 10.0 bar.

Connections

Henrad Plan Vertical Concept has 4 x 1/2" BSP connections (BOE) as standard.

Paint Process

Two coat paint process, each Henrad radiator is subjected to a multi-stage cleaning and paint process.

The final powder coat is Slate grey (RAL A7015) which is stoved and cooled to give a perfect finish.

Water Treatment

Installation of the system should be properly flushed and fitted in accordance with the British Code of Practice for the Treatment of Water in Domestic Hot Water Central Heating Systems.

Warranty

Henrad Plan Vertical Concept comes with a 5 year manufacturer's warranty.

Henrad (UK) Limited, Marriott Road,
Mexborough, South Yorkshire S64 8BN.
Telephone: 0800 876 6813

www.henrad.co.uk

Henrad Plan Vertical Concept

Wall Mounting Information

All dimensions in mm.

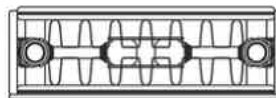

Mounting Bracket Information

All dimensions in mm.

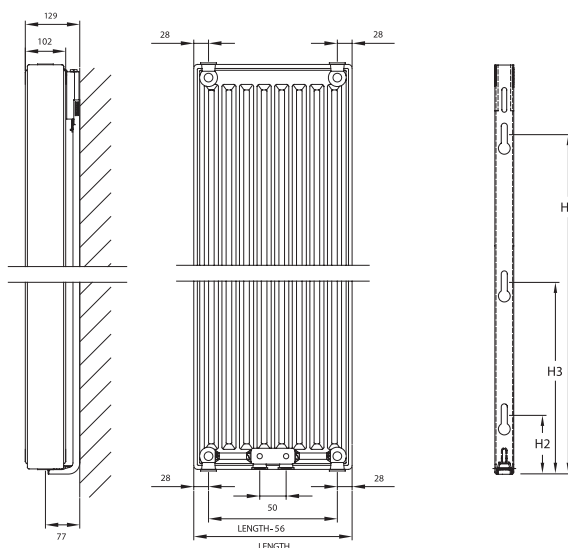

Height	H2	H3	H4
1800	89	849	1609

Connections

Each radiator comes with 1/2" inlet connections as standard.

Lug Positions

All dimensions in mm.

Length	400	500	600
	110	160	210